



! When the arm with rubber bedding is replaced by the improved version, replace both left and right arm !



**Track Control arm
BMW (E46)**

Sidem Nr.
21674 R
21675 R

Reference nr.
31 12 6 777 851 R
31 12 6 777 852 R

Problem:

- Early wear of rubber bedding Ball Joint.
- Play on ball joint.
- Early wear Silent block

Cause:

- Weak connection by rubber between inner and outer bushing.
- Damaged dustcover.
- Wrong method of mounting silent block.

Solution:

- A new ball joint is progressed without the rubber core.
- A cover is added to protect the pin and the dustcover during transport and storage.
- A document is added with mounting tips.

Original:

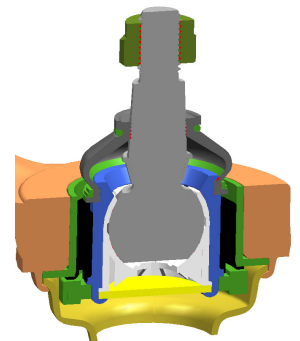

Improved:

